

Installation manual Unimi-1baseQC

- Unimi-1baseQC is intended for anchoring of larger charging stations – typically DC 50-100 kW.
- Due to its symmetrical shape and adaptor solution the foundation is positioning neutral and can be rotated in 90, 180 and 270 degrees in relation to its surrounding without compromising station facing.

Unimi-1baseQC

- Weight: ~ 450 kg
- Length: 600 mm
- Width: 600 mm
- Height: 1000 mm

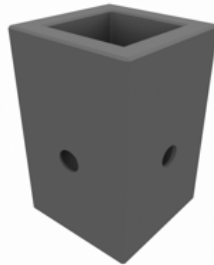

Adaptors

- Weight: 25 - 35 kg
- Length: 600 - 750 mm
- Width: 600 - 750 mm
- Height: 20 - 300 mm



- Chosen charging station is anchored to Unimi-1baseQC by means of a station specific adaptor via the 8 M10 anchors at the top or via 8 M12 anchors at the foundation's sides.
- Cable conduits (110 mm) is laid leading into the foundation opening(s)
- Minimum recommended foundation cavity LxBxH: 1400x1400x1100 mm
- Cavity bottom should be levelled via packable, drainable gravel masses.
- Top of foundation should be 0-100 mm above final ground level. Although not a necessity, if adaptor with attachment on foundation sides is used, it will generally be more practical to position the foundation 100 mm above final ground level as the attaching screws can be accessed freely.
- Surrounding masses of foundation should be packed 2-3 times to ensure stability.
- Local building codes, if any, apply and supersede these guidelines if in conflict.
- If integrated crash protections shall be installed on the foundation they will be attached either via existing M12 anchors at the side of the foundation or by drilling thru foundation walls and use threaded rods with nuts on both sides. Attachment means are included in the protections. The fastening screws of the bollards should be positioned above final ground level so that damaged bollards easily can be switched out.
- Questions will be answered on info@unimi.se or by calling +46 734 435245

Unimi	<i>Kap</i> -	<i>Kostnb.</i> K00717	<i>Dok namn</i> Installationsbeskrivning			
<i>Mallens filnamn</i> Produktbeskrivning.doc	<i>Dok dat</i> -	<i>Aktuellt filnamn</i> Produktbeskrivning - Universell förankring_v02	<i>Gäller fr o m</i> 2014-01-20	<i>Rev</i> 02	<i>Godkänd</i> 2014-01-20	<i>Sid</i> 1 (2)



Tritium 50 kW station on Unimi-1baseQC including integrated protection bollards. This adaptor model is fastened via M12 anchors at the foundation sides. Protection bollards has been fastened by using drilled thru threaded rods + nuts

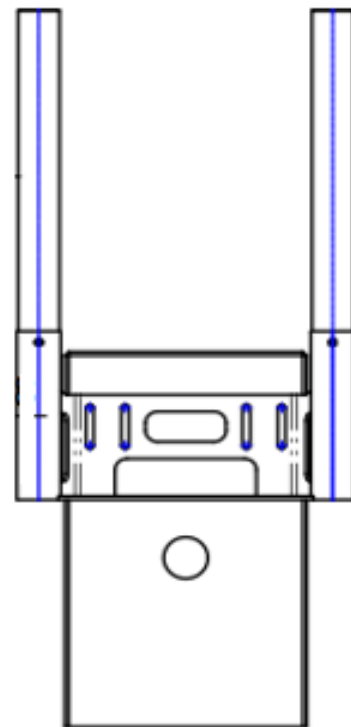

Blueprint of Unimi-1baseQC with integrated protection bollards.

Unimi	Kap -	Kostnb. K00717	Dok namn Installationsbeskrivning			
Mallens filnamn Produktbeskrivning.doc	Dok dat -	Aktuellt filnamn Produktbeskrivning - Universell förankring_v02	Gäller fr o m 2014-01-20	Rev 02	Godkänd 2014-01-20	Sid 2 (2)

